

APPLICATION NOTE

MECHANICAL FITTINGS

Revision Record:

Date	Description	Written by	Rev.
15/11/2005	1 st release	Zohar Petel	1.00

This document contains proprietary information that is the sole property of **Solid Applied Technologies Ltd.** The document is submitted to the recipient for his use only. By receiving this document; the recipient undertakes not to duplicate or to disclose, in part or the whole, any of the information contained herein; to any third party; without a-priory written permission from **Solid Applied Technologies Ltd.**

1.	SCOPE	3
2.	OBJECTIVES	3
3.	MECHANICAL FITTINGS	4
3.1	Mechanical Fitting Types	4
3.2	MonoScan Connections	4
3.2.1	MonoScan Mechanical Fittings	4
3.2.2	Conduit Box	5
3.2.3	MonoScan IP 67/NEMA 6	5
3.3	MicroScan	5
3.3.1	MicroScan Mechanical Fittings	5
3.4	SmartScan & SmartLite	6
3.4.1	SmartScan Mechanical Fittings	6

1. SCOPE

This document provides an introduction to mechanical fitting types in Europe and North-America and their fit of use with Solid AT's products in various environments according to the units' connections.

2. OBJECTIVES

- Familiarize the user with mechanical fitting types
- Familiarize the user with various connections used by Solid AT.

3. MECHANICAL FITTING TYPES

3.1 MECHANICAL FITTING TYPES

The most commonly used fittings:

- Gland
- Conduit ½" NPT
- Conduit M20

The European mechanical fittings are based on gland, conduit M20 connections.

North American mechanical fittings are based on conduit ½" NPT.

3.2 MONOSCAN CONNECTIONS

3.2.1 MonoScan Mechanical Fittings

- Connector connection Pg7
- Conduit connection 1/2" NPT
- Conduit connection M20 x 2.5

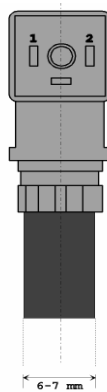

Figure 1: MonoScan Connector Front View



NOTE:

The cable for the mating connector must be at least 6 mm in diameter.

3.2.2 Conduit Box

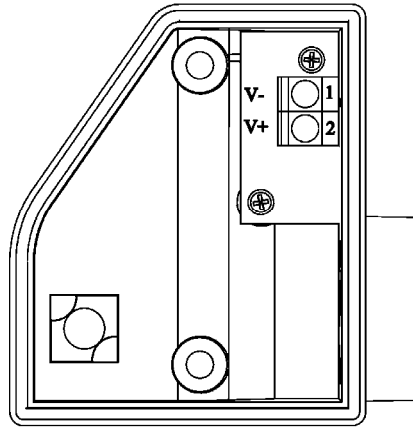

Figure 2: MonoScan Conduit Adapter



NOTE:

The conduit adapter should not exceed a torque of 50 lb/In.
To maintain the MonoScan properly sealed, make sure that conduit is firmly screwed to the conduit's adaptor.

3.2.3 MonoScan IP 67/NEMA 6

The MonoScan EX with conduit connection is suitable for IP 67/NEMA6.

3.3 MICROSCAN

3.3.1 MicroScan Mechanical Fittings

- Gland connection (to fit 1/2" NPT)
- Conduit connection 1/2" NPT
- Conduit connection M20 x 2.5

Use a conduit connector that is either 1/2" NPT or M20 x 2.5 compatible (depending on your MicroScan model) to ensure the unit will remain sealed.



NOTE:

The conduit adapter should not exceed a torque of 50 lb/In.
To maintain the MicroScan properly sealed, make sure that conduit is firmly screwed to the conduit's adaptor.

3.4 SMARTSCAN & SMARTLITE

3.4.1 SmartScan Mechanical Fittings

- Gland connection Pg9
- Conduit connection 1/2" NPT
- Conduit connection M 20 x 2.5

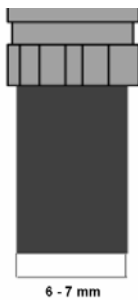

Figure 4: SmartScan Gland Connection



NOTE:

In order to ensure that the unit remains sealed, make sure to use round cables (for gland fitting) with a minimum of 6-7 mm diameter.

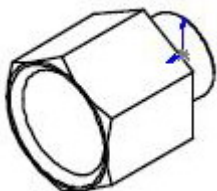

Figure 5: SmartScan Conduit Connection



NOTE:

The conduit adapter should not exceed a torque of 250 lb/In.